

ERA FLUSH-MOUNTING PLASTIC DISTRIBUTION BOARDS (IP30)



- for building, residential and similar installations
- also suitable for setting into hollow walls
- for mounting devices on DIN EN 60715 rail of width 35 mm with cut-out in 45 mm cover plate
- installed devices: max. 63 A, 520 V
- distribution boards consist of a base, mounting frame, front cover, door, and mounting anchors (4 pcs) for installation into hollow walls
- mounting frame can be adjusted horizontally (up to 2°) for correction of an askew mounted cabinet base
- at top and bottom of distribution board base can be found knock-out cable pass-throughs for easy installation of cables from below and above
- standard package contains:
 - PE and N terminal blocks
 - DIN EN 60715 sliding rails of width 35 mm
 - labels
 - blank covers for filling unused cut-outs in cover plate in distribution board colour (1 pc / row)
- colour: white
- door: transparent or non-transparent with possibility for installation on the right or left side
- resistance rating class: II



Flush-mounting distribution boards

Door	Number of rows	Maximum number of modules in a row (total) ¹⁾	Type	Product code	Maximum power loss [W] ²⁾	Weight [kg]	Packing [pcs]
Non-transparent	1	14 (14)	ERA-14N	15577	17.8	1.46	1
	2	14 (28)	ERA-28N	15578	26.0	2.34	1
	3	14 (42)	ERA-42N	15579	35.1	3.40	1
Transparent	1	14 (14)	ERA-14P	15580	17.8	1.48	1
	2	14 (28)	ERA-28P	15581	26.0	2.40	1
	3	14 (42)	ERA-42P	15582	35.1	3.48	1

¹⁾ 1 module = 17.5 mm

²⁾ ΔT = 30 K (difference between internal and external temperature)

Accessories for ERA

Terminal block holder	DSB-OC	page C15
PE and N terminal blocks	SB6, SB10, SB14	page C15
Blank covers	ZAS-G	page C15

Specifications

Type	ERA
Standards	EN 60439-1, EN 60439-3, EN 62208
Approval marks	
Colour	white
Protection	IP30
Rated values of devices used	max. 63 A, 520 V
Device rail	DIN EN 60715 rail of width 35 mm
Resistance rating class	II
Door	opening version
	to the side - left/right
	transparent / non-transparent
Material	flame retardant thermoplastic - glow wire test
	max. 850 °C *

* For mounting on materials of A and B (EN 13501-1) flammability ratings

ERA FLUSH-MOUNTING PLASTIC DISTRIBUTION BOARDS (IP30)

Dimensions

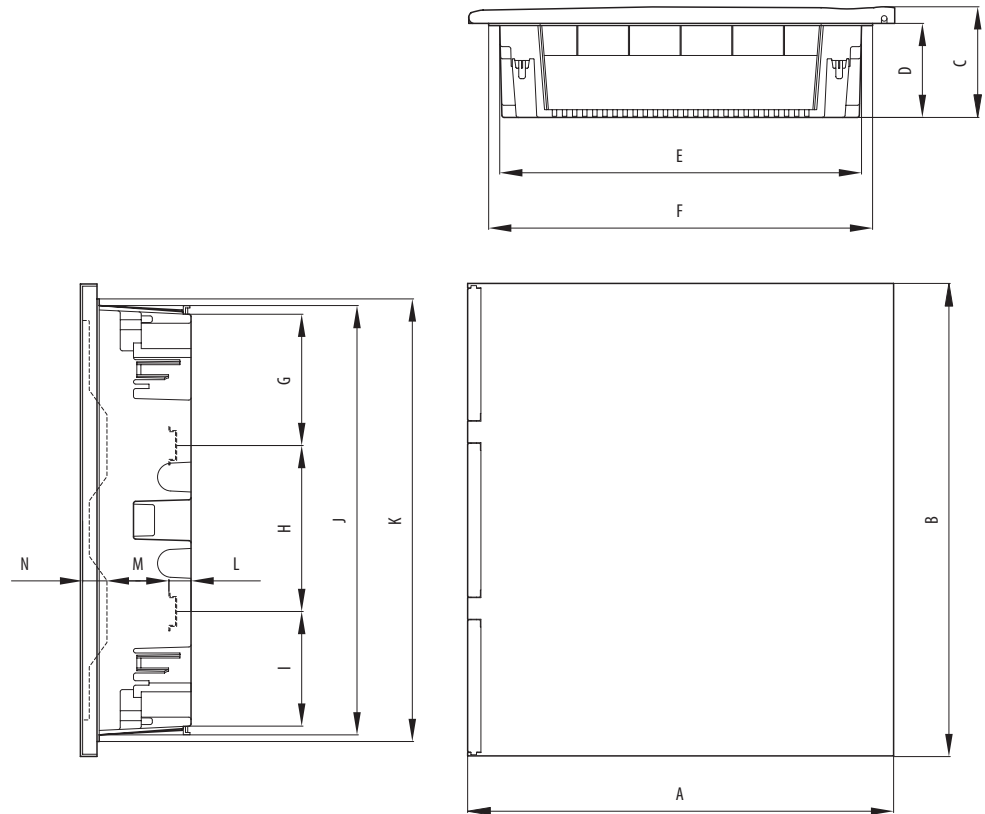

Flush-mounting distribution boards - ERA series [mm]

Dimension	Type		
	ERA-14...	ERA-28...	ERA-42...
A	385	385	385
B	277	427	597
C	100	100	100
D	85	85	85
E	327	327	327
F	347	347	347
G	115	115	135
H	-	150	2x150
I	100	100	100
J	230	380	550
K	250	400	570
L	20	20	20
M	49	49	49
N	26	26	26

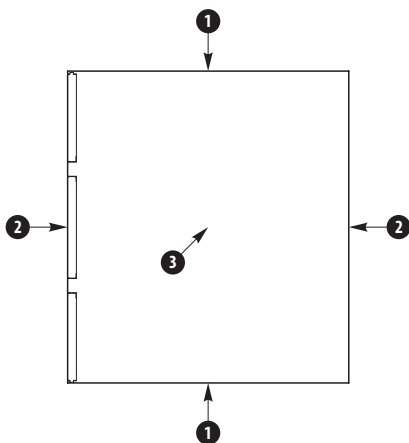

Prepressed for outlets with nut and installed PE and N terminal blocks

Type of distribution board	Prepressed for outlets with nut - side			Inserted PE and N terminal blocks ²⁾	Number of available plates ³⁾
	1 ¹⁾	2	3		
ERA-14...	-	2x Ø 25	2x Ø 40-32 + 4x Ø 25	1xSB14 a 1xSB14	3
ERA-28...	-	2x Ø 25	2x (Ø 40-32 + 2x Ø 25) + 2x Ø 25	2xSB10 a 2xSB10	2
ERA-42...	-	3x Ø 25	4x (Ø 40-32 + 2x Ø 25)	2xSB14 a 2xSB14	2

¹⁾ removable knock-out cable pass-throughs

²⁾ SB6=2x16 mm² + 4x10 mm², SB10=2x16 mm² + 8x10 mm², SB14=2x16 mm² + 12x10 mm²

³⁾ Each PE and N pair is placed in a DSB-OC holder, which is affixed onto the plates at the top/bottom of the distribution board; if needed, additional DSB-OC holders with PE and N (SB6, SB10, SB14) terminal strips may be placed on available plates - see accessories